

**COUNTY OF LOS ANGELES**  
**ROAD DEPARTMENT**

**PRECISE**  
**BENCH MARK LIST**



**FAIRFAX QUAD**

**1975 ADJUSTMENT**

## P R E F A C E

The Road Department level net is composed of more than 1,500 miles of levels supporting in excess of 18,000 bench marks. In 1975, a major readjustment of the net was undertaken. To emphasize the complete break with previous elevations, the BY,BG & BL series bench marks have been relabeled CY,CG & CL, respectively.

To facilitate the adjustment, indexing, and distribution of adjusted values of the net, the County territory is divided into 34 quads or areas. For identification purposes each quad is given a name, viz., "Rosemead," "La Mirada," "Santa Fe," etc. When bench marks and elevations in the Road Department net are used, the name of the quad in which the bench mark is located and the date of the adjustment of the elevation must be included in the bench mark description, e.g.,

CG 6234 --L+BN IN CONC HDWL OF DRAIN PIPE UNDER DR 218 FT  
NE+18 FT SE C/L INT GRAND AVE + CAMERON AVE MKD (BM)  
(COVINA --1975) ELEV. 696.238

Experience indicates that this general adjustment will, for the most part, remain sound for the next 10 years. Updating constrained adjustments will be made in 5 years. It is expected that these updating adjustments will be in the nature of a few hundredths of a foot. When a quad is readjusted, new elevation lists will be published and the date of the readjustment will replace the "1975" at the end of the bench mark description. Two bench marks with different adjustment dates will not normally agree with each other.

The basic accuracy of the net is reflected by an indicated field probable error of plus or minus 0.012 foot per mile of leveling as determined from over 600 conditions of closure. However, many years experience in vertical control in the greater Los Angeles basin and Antelope Valley indicate that because of varying degrees of subsidence and heaving, the true datum is recovered only by obtaining substantial agreement of a number of bench marks.

The users of this net are invited to assist in its maintenance by notifying this Department of cases of obliteration, apparent mistakes in descriptions or elevations, and proven disturbance of bench marks.

---

DATUM: U. S. Coast and Geodetic Survey Sea Level Datum  
of 1929, through the medium of the Los Angeles  
County Engineer Precise Level Net.

---

ABBREVIATIONS USED IN BENCH MARK LISTINGS

ABUT - - - - -	Abutment	EC - - - - -	End of Curve
ALG - - - - -	Along	ENT - - - - -	Entrance
ANG PT - - - - -	Angle Point	FL - - - - -	Floor
B/W - - - - -	Back of Walk	FTG - - - - -	Footing
BCR - - - - -	Beginning of Curb Return	F/W - - - - -	Front of Walk
BC - - - - -	Beginning of Curve	GAR - - - - -	Garage
BLDG - - - - -	Building	HDWL - - - - -	Headwall
BM - - - - -	Bench Mark	HSE - - - - -	House
BT SPK - - - - -	Boat or Bolt Spike	INT - - - - -	Intersection
BR CAP - - - - -	Brass or Bronze Cap	IP - - - - -	Iron Pipe
C B - - - - -	Catch Basin	LT - - - - -	Left
CTR - - - - -	Center	LACE - - - - -	L. A. City Engineer
C/L - - - - -	Center Line	LACS - - - - -	L. A. County Engineer
C/L INT - - - - -	Center Line Intersection	L AFC - - - - -	L. A. Co. Flood Control
C/L PROD - - - - -	Center Line Produced	L+BN - - - - -	Lead and Bench Nail
CONC - - - - -	Concrete	L+BR - - - - -	Lead and Brad
COR - - - - -	Corner	L+N - - - - -	Lead and Nail
COE - - - - -	Corps of Engineers	L+RDBM TAG - - - - -	Lead and Road Dept. Bench Mark Tag
CULV - - - - -	Culvert	L+SPK - - - - -	Lead and Spike
CB - - - - -	Curb	L+T - - - - -	Lead and Tack
CS MON - - - - -	County Engineer Monument	MCR - - - - -	Middle of Curb Return
CS BR CAP - - - - -	County Engineer Brass Cap	MKD - - - - -	Marked
CT SPK - - - - -	Cut Spike	MC - - - - -	Middle of Curve
DR - - - - -	Drive or Driveway	MON - - - - -	Monument
E/O - - - - -	East of	N/O - - - - -	North of
ECR - - - - -	End of Curb Return	NR - - - - -	Near

ABBREVIATIONS USED IN BENCH MARK LISTINGS . . . CONTINUED

OPP - - - - - Opposite  
PI - - - - - Point of Intersection  
PK+W - - - - - PK Nail and Washer  
P/L - - - - - Property Line  
POST - - - - - Point on Semi-Tangent  
PP - - - - - Power Pole  
PVMT - - - - - Pavement  
PROD - - - - - Produced  
RD - - - - - Road  
RDEM - - - - - Road Dept. Bench Mark  
RR - - - - - Railroad  
RT - - - - - Right  
R/W - - - - - Right of Way  
SDMH - - - - - Storm Drain Manhole  
SMH - - - - - Sewer Manhole  
SPK - - - - - Spike  
ST+W - - - - - Spike Tin and Washer  
S/O - - - - - South of  
TP - - - - - Telephone Pole  
USC+GS - - - - - U. S. Coast and Geodetic Survey  
USGS - - - - - U. S. Geological Survey  
WK - - - - - Walk  
W/O - - - - - West of

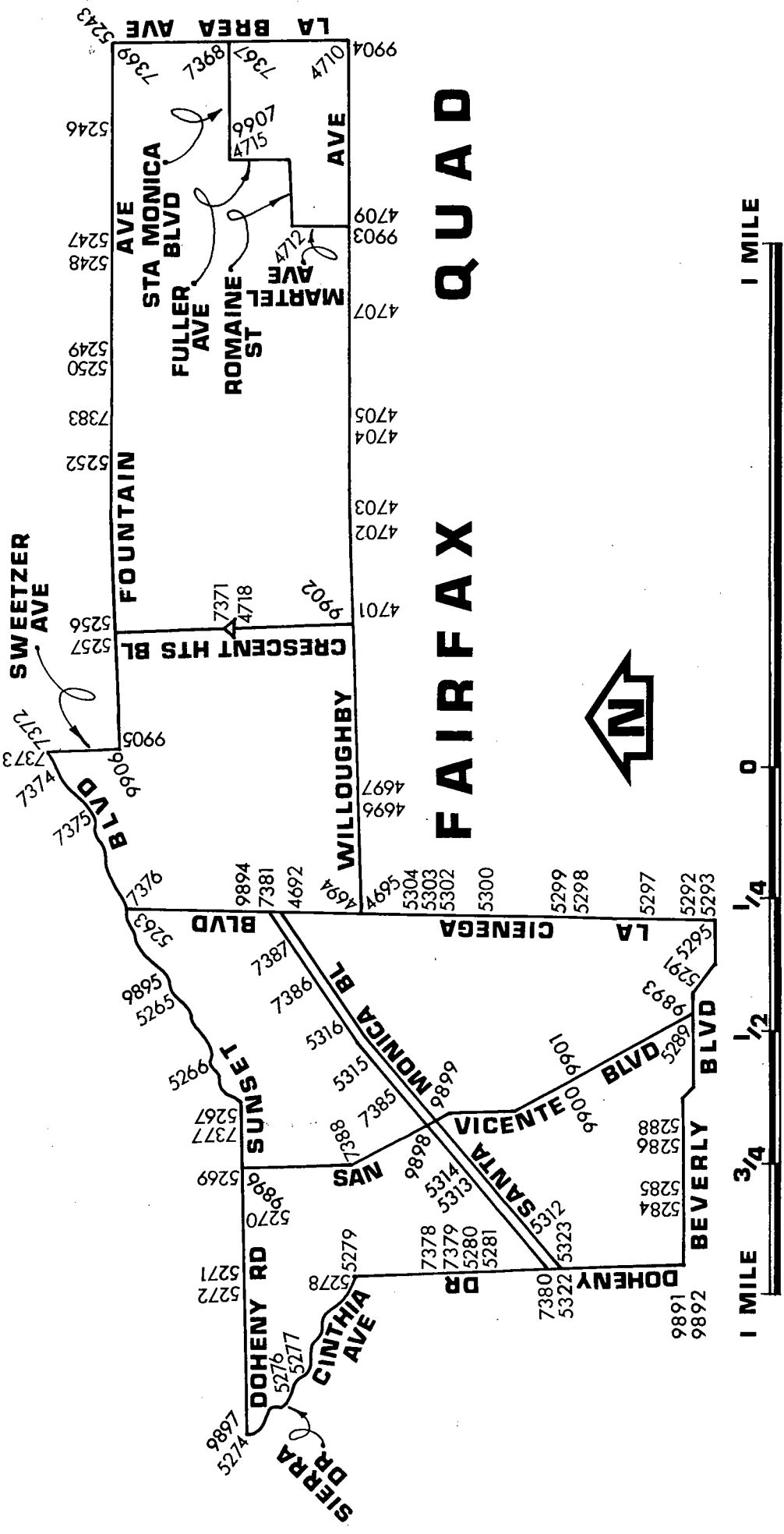

# FAIRFAX QUAD



SCALE

QUAD-YEAR	ELEV	DESCRIPTION (INCLUDE QUAD AND YEAR IN DESCRIPTION)	BM NUMBER
FAIRFAX (1975)	228.003	LA CITY SUR MON IN WELL 12IN DN ON C/L LA CIENEGA BLVD & 66FT N/O C/L ROMAINE ST MKD (C-2A RESET 1970)	CY 4692
FAIRFAX (1975)	203.250	FLAT HD SPK E CB 6FT N BCR 33FT E C/L LA CIENEGA BLVD & 35FT N C/L WILLOUGHBY AVE	CY 4694
FAIRFAX (1975)	202.488	WIRE SPK S CB 15FT E BCR 15FT S C/L WILLOUGHBY AVE & 60FT E C/L LA CIENEGA BLVD	CY 4695
FAIRFAX (1975)	212.997	L&T W CB 4FT N BCR 24FT N C/L WILLOUGHBY AVE & 18FT W C/L ORLANDO AVE	CY 4696
FAIRFAX (1975)	212.157	WIRE SPK 4FT S BCR 21FT E C/L ORLANDO AVE & 30FT S C/L WILLOUGHBY AVE	CY 4697
FAIRFAX (1975)	238.237	L&BN S CB 15FT E/O BCR 15FT S/O C/L WILLOUGHBY AVE & 50FT E/O C/L CRESCENT HEIGHTS BLVD	CY 4701
FAIRFAX (1975)	258.353	L&T W CB 3FT N/O BCR 30FT N/O C/L WILLOUGHBY AVE & 15FT W C/L GENESEE AVE	CY 4704
FAIRFAX (1975)	258.599	L&T E CB GENESEE AVE 12FT N BCR @ NE COR WILLOUGHBY AVE	CY 4705
FAIRFAX (1975)	261.092	WIRE SPK N CB 6FT E BCR 15FT N C/L WILLOUGHBY AVE & 33FT E C/L SIERRA BONITA AVE	CY 4707
FAIRFAX (1975)	257.134	WIRE SPK E CB 4FT S BCR 35FT S C/L WILLOUGHBY AVE & 15FT E C/L MARTEL AVE	CY 4709
FAIRFAX (1975)	268.606	WIRE SPK W CB LA BREA AVE 4FT N/O N P/L WILLOUGHBY AVE 40FT W/O C/L LA BREA AVE	CY 4710
FAIRFAX (1975)	272.655	WIRE SPK W CB MARTEL AVE C/L PROD ROMAINE ST FROM THE E	CY 4712
FAIRFAX (1975)	281.484	L&T S CB 10FT E BCR 40FT E C/L FULLER AVE & 30FT S C/L SANTA MONICA BLVD	CY 4715
FAIRFAX (1975)	276.939	CHIS X E RIM TEL MH 4FT S OF S CB SANTA MONICA BLVD & 6FT E OF E P/L HAVENHURST DR	CY 4718
FAIRFAX (1975)	309.801	STD TRAVERSE MON C/L LA BREA AVE 4FT N C/L FOUNTAIN AVE MKD (HWD G1C)	CY 5243
FAIRFAX (1975)	311.371	RDBM TAG W CB ALTA VISTA BLVD 95FT N & 20FT W C/L INT ALTA VISTA BLVD & FOUNTAIN AVE	CY 5246
FAIRFAX (1975)	312.150	RDBM TAG E CB VISTA ST 15FT E & 100FT S C/L INT VISTA ST & FOUNTAIN AVE	CY 5247

QUAD-YEAR	ELEV	DESCRIPTION (INCLUDE QUAD AND YEAR IN DESCRIPTION)	BM NUMBER
FAIRFAX (1975)	318.270	RDBM TAG W CB VISTA ST 16FT W & 100FT N C/L INT VISTA ST & FOUNTAIN AVE	CY 5248
FAIRFAX (1975)	329.625	RDBM TAG E CB CURSON AVE 14FT E & 150FT N C/L INT CURSON AVE & FOUNTAIN AVE	CY 5249
FAIRFAX (1975)	329.638	RDBM TAG W CB CURSON AVE 14FT W & 150FT N C/L INT CURSON AVE & FOUNTAIN AVE	CY 5250
FAIRFAX (1975)	329.100	RDBM TAG W CB GENESEE AVE 15FT W & 110FT S C/L INT GENESEE AVE & FOUNTAIN AVE	CY 5252
FAIRFAX (1975)	339.731	RDBM TAG E CB 32FT E C/L CRESCENT HEIGHTS BLVD & 83FT S C/L FOUNTAIN AVE	CY 5256
FAIRFAX (1975)	340.430	RDBM TAG W CB 32FT W C/L CRESCENT HEIGHTS BLVD & 65FT S C/L FOUNTAIN AVE	CY 5257
FAIRFAX (1975)	409.579	CUT SPK S CB @ E END CATCH BASIN 2FT W BCR @ SW COR SUNSET BLVD & MILLER DR	CY 5263
FAIRFAX (1975)	384.685	L&BN W CB @ N END C B 30FT W/O C/L SUNSET PLAZA DR & 100FT N/O C/L SUNSET BLVD	CY 5265
FAIRFAX (1975)	360.114	CUT SPK N CB SUNSET BLVD 33FT E OF E CB SHERBOURNE DR @ W END C B 34FT N & 43FT W/O C/L INT	CY 5266
FAIRFAX (1975)	343.090	CUT SPK N CB SUNSET BLVD 27FT W OF W CB HORN AVE @ E END C B 34FT N & 43FT W/O C/L INT	CY 5267
FAIRFAX (1975)	360.669	L&FLAT HD SPK NR CTR OF NW CB RET SUNSET BLVD & CLARK ST 40FT N & 25FT W/O C/L INT	CY 5269
FAIRFAX (1975)	376.082	WIRE SPK E CB HILLDALE AVE 25FT N OF N CB SUNSET BLVD @ S END C B 60FT N & 17FT E/O C/L INT	CY 5270
FAIRFAX (1975)	411.087	CUT SPK W CB DOHENY DR 60FT N OF N P/L SUNSET BLVD @ S END C B 106FT N & 20FT W/O C/L INT	CY 5271
FAIRFAX (1975)	406.405	CUT SPK N CB 5FT W BCR @ NW COR SUNSET BLVD & DOHENY DR 47FT W & 35FT N C/L INT MKD (BM)	CY 5272
FAIRFAX (1975)	455.668	L&BR NR CTR CURVE @ SW COR DOHENY RD & SIERRA PL 33FT S & 35FT W C/L INT STAMPED (BM)	CY 5274
FAIRFAX (1975)	399.204	CUT SPK IN N CB SUNSET BLVD 42FT N/O C/L & 202FT E/O C/L SIERRA DR TO NORTH @ SW END C B	CY 5276

QUAD-YEAR	ELEV	DESCRIPTION (INCLUDE QUAD AND YEAR IN DESCRIPTION)	BM NUMBER
FAIRFAX (1975)	396.700	L&N 1FT E BCR @ SE COR SUNSET BLVD & SIERRA DR 42FT S & 202FT E/O C/L INT TO NORTH	CY 5277
FAIRFAX (1975)	312.894	ROUND HD SPK W CB 5FT N/O BCR @ NW COR CINTHIA ST & DOHENY DR 25FT W & 70FT N/O C/L INT MKD (BM)	CY 5278
FAIRFAX (1975)	310.161	L&T E CB 6FT N BCR @ NE COR DOHENY DR & CINTHIA ST 25FT E & 35FT N/O C/L INT	CY 5279
FAIRFAX (1975)	253.919	CS MON IN WELL 10IN DN @ C/L INT DOHENY DR & LLOYD PL (USE W EDGE)	CY 5280
FAIRFAX (1975)	253.540	WIRE SPK E CB 1FT S BCR @ SE COR DOHENY DR & LLOYD PL 25FT E & 25FT S C/L INT	CY 5281
FAIRFAX (1975)	199.208	SPK&W IN E CB @ SE COR WETHERLY DR & BEVERLY BLVD 15FT E & 70FT S/O C/L INT (10FT S/O BCR)	CY 5284
FAIRFAX (1975)	193.616	L&N IN N CB @ BCR @ NW COR BEVERLY BLVD & ALMONT DR 35FT N & 35FT W/O C/L INT MKD (BM)	CY 5285
FAIRFAX (1975)	184.978	WIRE SPK S CB BEVERLY BLVD 17FT W OF W P/L SWALL DR @ E END C B 35FT S & 45FT W/O C/L INT	CY 5286
FAIRFAX (1975)	181.546	LACE HEX MON IN WELL 8IN DN C/L BEVERLY BLVD & 143FT E C/L SWALL DR	CY 5288
FAIRFAX (1975)	167.857	LACE HEX MON IN WELL 8IN DN C/L BEVERLY BLVD & 250FT W/O W CB LINE SHERBOURNE DR 265FT W/O C/L INT (LA 13 14750)	CY 5289
FAIRFAX (1975)	163.271	CUT SPK @ SE COR CATCH BASIN 4FT E OF E CB HUNTLEY DR & 3FT N/O N P/L BEVERLY PL 19FT E/O C/L HUNTLEY DR & 30FT N/O C/L BEVERLY PL	CY 5291
FAIRFAX (1975)	162.558	WIRE SPK N CB BEVERLY BLVD 18FT E OF E P/L LA CIENEGA BLVD 1FT W OF CATCH BASIN 35FT N/O & 70FT E/O C/L INT	CY 5292
FAIRFAX (1975)	161.300	LA CITY MON IN WELL 10IN DN @ C/L INT BEVERLY BLVD & LA CIENEGA BLVD MKD (HOLLYWOOD C-3A 1948)	CY 5293
FAIRFAX (1975)	160.537	USC&GS DISC CONC POST 165FT S OF S CB BEVERLY BLVD & 1FT W OF W CB LA CIENEGA BLVD MKD (USC&GS BM F-775-1945)	CY 5295
FAIRFAX (1975)	168.214	CUT SPK SE COR CATCH BASIN 4FT E OF E CB LA CIENEGA BLVD 5FT N OF N P/L OAKWOOD ST 38FT E & 30FT N/O C/L INT	CY 5297



QUAD-YEAR	ELEV	DESCRIPTION (INCLUDE QUAD AND YEAR IN DESCRIPTION)	BM NUMBER
FAIRFAX (1975)	174.049	WIRE SPK S CB ROSEWOOD AVE 5FT E OF E P/L LA CIENEGA BLVD @ E END C B 15FT S & 56FT E/O C/L INT MKD (BM)	CY 5298
FAIRFAX (1975)	172.832	LA CITY HEX MON IN WELL 15IN DN ON C/L LA CIENEGA BLVD & 10FT S/O C/L ROSEWOOD AVE E	CY 5299
FAIRFAX (1975)	176.140	USC&GS MON FLUSH 1FT W/O W CB LA CIENEGA BLVD & 250FT S/O S CB MELROSE AVE MKD (USC&GS BM J-775-1945)	CY 5300
FAIRFAX (1975)	185.272	LA CITY MON IN WELL 18IN DN @ C/L INT LA CIENEGA BLVD & MELROSE PL MKD (C-2B RESET 1970)	CY 5302
FAIRFAX (1975)	186.657	CUT SPK @ NW COR CATCH BASIN 4FT N OF N CB MELROSE PL & 3FT E/O E P/L LA CIENEGA BLVD 28FT N & 51FT E/O C/L INT	CY 5303
FAIRFAX (1975)	192.863	WIRE SPK E CB LA CIENEGA BLVD 9FT N OF N P/L WARING AVE @ S END C B 36FT N & 34FT E/O C/L INT MKD (BM)	CY 5304
FAIRFAX (1975)	224.307	USC&GS DISC 2FT N OF N CB SANTA MONICA BLVD 1FT E/O BCR @ NW COR NEMO ST MKD (T733-1945)	CY 5312
FAIRFAX (1975)	224.404	USC&GS DISC CONC POST 2FT N OF N CB SANTA MONICA BLVD 271FT W OF W CB ROBERTSON BLVD MKD (U 7331945)	CY 5313
FAIRFAX (1975)	221.026	CUT SPK N CB SANTA MONICA BLVD 11FT W OF W P/L HILDALE AVE @ E END C B 36FT W & 20FT N/O C/L INT NORTH BARREL	CY 5314
FAIRFAX (1975)	211.261	SQ HD SPK N CB 1FT E BCR @ NE COR SANTA MONICA BLVD & PALM AVE 20FT N C/L N BARREL & 56FT E/O C/L INT MKD (BM)	CY 5315
FAIRFAX (1975)	210.221	WIRE SPK N CB 3FT E BCR @ NE COR SANTA MONICA BLVD & HANCOCK AVE 20FT N C/L N BARREL & 45FT E/O C/L INT MKD (BM)	CY 5316
FAIRFAX (1975)	226.455	CUT SPK N CB SANTA MONICA BLVD MIDWAY BETWEEN DOHENY DR & OAKHURST DR @ E END CATCH BASIN	CY 5322
FAIRFAX (1975)	225.624	CS MON IN WELL 12IN DN 3FT E C/L DOHENY DR & 20FT N C/L N BARREL SANTA MONICA BLVD (USE W EDGE)	CY 5323
FAIRFAX (1975)	286.396	L&BN S CB SANTA MONICA BLVD 2FT W C B @ SE COR SANTA MONICA BLVD & LA BREA AVE 27FT S & 53FT E C/L INT	CY 7367

QUAD-YEAR	ELEV	DESCRIPTION (INCLUDE QUAD AND YEAR IN DESCRIPTION)	BM NUMBER
FAIRFAX (1975)	285.077	LACE TRAV MON 12IN DN ON C/L LA BREA AVE 20FT N C/L SANTA MONICA BLVD MKD (CITY OF L A ENG MON G-2)	CY 7368
FAIRFAX (1975)	309.321	L&BN S CB FOUNTAIN AVE 10FT W BCR @ SW COR LA BREA AVE & FOUNTAIN AVE 27FT S & 60FT W C/L INT	CY 7369
FAIRFAX (1975)	275.820	SUR MON 14IN DN ON C/L HAVENHURST DR PROD FROM S & 22FT N C/L SANTA MONICA BLVD MKD (HOLLYWOOD E-2-A)	CY 7371
FAIRFAX (1975)	388.457	CS BR CAP MON IN NW COR OF CULV @ NE COR SUNSET BLVD & SWEETZER AVE 36FT N & 25FT E C/L INT MKD (BM 62-6)	CY 7372
FAIRFAX (1975)	388.526	WIRE SPK N CB SUNSET BLVD @ E END C B LOC 25FT E/O E CB LN SWEETZER AVE 35FT E & 30FT N C/L INT	CY 7373
FAIRFAX (1975)	387.433	WIRE SPK N CB SUNSET BLVD 5FT W BCR @ NW COR SUNSET BLVD & SWEETZER AVE 30FT N & 32FT W C/L INT	CY 7374
FAIRFAX (1975)	392.422	WIRE SPK 4FT W BCR @ NW COR KINGS RD & SUNSET BLVD 30FT N & 34FT W C/L INT	CY 7375
FAIRFAX (1975)	404.935	L&BN 10FT E BCR @ SE COR SUNSET BLVD & LA CIENEGA BLVD 45FT E & 33FT S C/L INT	CY 7376
FAIRFAX (1975)	343.532	USGS BR DISC FL BK OF WK @ ENT TO BLDG NO 8820 SUNSET BLVD 79FT W OF W CB LINE OF HORN ST PROD MKD ( 6-1922 )	CY 7377
FAIRFAX (1975)	262.430	CS MON 12IN DN @ C/L INT DOHENY DR & ELEVADO AVE FROM THE WEST 35FT S S M H MKD (CO ENG MON)	CY 7378
FAIRFAX (1975)	262.705	WIRE SPK E CB DOHENY DR 2FT S BCR @ SE COR ELEVADO AVE 20FT W & 22FT S/O C/L INT	CY 7379
FAIRFAX (1975)	231.196	BR SCREW IN LEAD IN W CB @ NW COR DOHENY DR & CARMELITA AVE 6FT N/O N END OF CURB RETURN	CY 7380
FAIRFAX (1975)	238.096	SPK IN N CB OF SANTA MONICA BLVD NORTH BARREL 2FT E BCR @ NE COR OF LA CIENEGA BLVD 85FT E & 13FT N C/L INT	CY 7381
FAIRFAX (1975)	334.019	L&BN E CB SPAULDING AVE 9FT N C B 17FT E & 93FT N C/L INT SPAULDING AVE & FOUNTAIN AVE	CY 7383

QUAD-YEAR	ELEV	DESCRIPTION (INCLUDE QUAD AND YEAR IN DESCRIPTION)	BM NUMBER
FAIRFAX (1975)	222.167	USC&GS STD BR DISC SET VERTICALLY IN NE COR OF BLDG @ NW COR SANTA MONICA BLVD & LARRABEE ST 9.6FT W OF W CB LINE LARRABEE ST & 125FT N C/L SANTA MONICA BLVD MKD (V-773 1945) MON IS 3FT UP FROM ALLEY ON NORTH SIDE OF BLDG FACING ALLEY N/O SANTA MONICA BLVD	CY 7385
FAIRFAX (1975)	217.217	USC&GS BR DISC IN E CB WESTBOURNE DR 16FT N BCR @ NE COR SANTA MONICA BLVD 42FT N & 23FT E C/L INT MKD (W 773 RESET 1962)	CY 7386
FAIRFAX (1975)	238.075	USC&GS BR DISC IN E CB WEST KNOLL DR 5FT N BCR @ NW COR SANTA MONICA BLVD 15FT E & 35FT N C/L INT (NORTH BARREL) MKD (X 773 RESET 1962)	CY 7387
FAIRFAX (1975)	275.815	L&T N CB CYNTHIA ST @ NW COR CYNTHIA ST & SAN VICENTE BLVD 20FT W/O BCR 18FT N & 95FT W/O C/L INT	CY 7388
FAIRFAX (1975)	208.350	L&N W CB 3FT N/O BCR @ NW COR DOHENY DR & BEVERLY BLVD 24FT W & 55FT N/O C/L INT	CY 9891
FAIRFAX (1975)	208.110	LAFC TAG IN S CB @ BCR @ SW COR DOHENY DR & BEVERLY BLVD 30FT S & 33FT W/O C/L INT	CY 9892
FAIRFAX (1975)	167.261	WIRE SPK IN N CB BEVERLY BLVD 4FT W/O BCR @ NW COR SHERBOURNE DR @ E END C B 35FT N & 93FT W/O C/L INT (LA 13 14740)	CY 9893
FAIRFAX (1975)	242.276	WIRE SPK 1FT W/O W CB LA CIENEGA BLVD & 75FT N/O N P/L SANTA MONICA BLVD @ S END C B 32FT W & 152FT N/O C/L INT	CY 9894
FAIRFAX (1975)	382.003	RDBM TAG IN N CB SUNSET BLVD 1FT E BCR @ NE COR 82FT E C/L SUNSET PLAZA DR & 42FT N/O C/L	CY 9895
FAIRFAX (1975)	355.214	L&T E CB 7FT S/O BCR @ SE COR SUNSET BLVD & SAN VICENTE BLVD 50FT E & 67FT S/O C/L INT	CY 9896
FAIRFAX (1975)	450.742	RDBM TAG IN S CB 1FT E/O BCR @ SE COR DOHENY RD & SIERRA PL 21FT S/O & 80FT E/O C/L INT	CY 9897
FAIRFAX (1975)	218.772	L&BN IN N CB 13FT W/O BCR @ NW COR SANTA MONICA BLVD & SAN VICENTE BLVD 67FT W & 54FT N/O C/L INT	CY 9898
FAIRFAX (1975)	214.599	L&SPK IN E CB 5FT S/O BCR @ SE COR SANTA MONICA BLVD & SAN VICENTE BLVD 60FT E & 79FT S/O C/L INT	CY 9899

QUAD-YEAR	ELEV	D E S C R I P T I O N (INCLUDE QUAD AND YEAR IN DESCRIPTION)	BM NUMBER
FAIRFAX (1975)	176.997	RDBM TAG IN W CB @ BCR @ S END C B @ NW COR SAN VICENTE BLVD & MELROSE AVE 46FT W & 69FT N/O C/L INT	CY 9900
FAIRFAX (1975)	174.702	LACE TAG IN S CB 4FT E/O BCR @ SE COR SAN VICENTE BLVD & MELROSE AVE 34FT S & 61FT E/O C/L INT	CY 9901
FAIRFAX (1975)	240.331	L&SPK E CB 10FT N/O BCR 22FT E/O C/L CRESCENT HGTS BLVD & 46FT N/O C/L WILLOUGHBY AVE	CY 9902
FAIRFAX (1975)	257.617	L&T S CB 9FT W/O BCR 44FT W/O C/L MARTEL AVE & 15FT S/O C/L WILLOUGHBY AVE	CY 9903
FAIRFAX (1975)	267.245	L&BR W CB 7FT S/O BCR 40FT W/O C/L LA BREA AVE & 36FT S/O C/L WILLOUGHBY AVE	CY 9904
FAIRFAX (1975)	316.165	L&T N CB 21FT N/O C/L FOUNTAIN AVE 56FT E/O C/L SWEETZER AVE (15FT E/O BCR)	CY 9905
FAIRFAX (1975)	312.616	L&T S CB 9FT W/O BCR 21FT S/O C/L FOUNTAIN AVE 60FT W/O C/L SWEETZER AVE	CY 9906
FAIRFAX (1975)	282.127	LA CITY BR CAP MON SW COR C B 33FT S/O C/L SANTA MONICA BLVD 16FT E/O C/L PROD FULLER AVE FM NO MKD (PBM-1970 13-15372)	CY 9907